

# OTHERS

## DETa-1 Collet Holder (DTA / DTB)

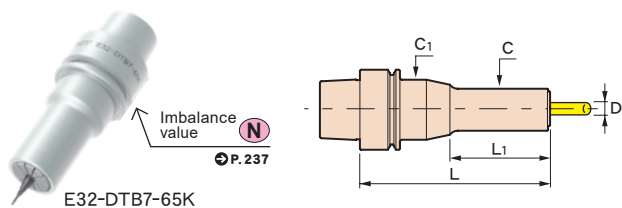

## DETa-1 Collet (Precision collet)

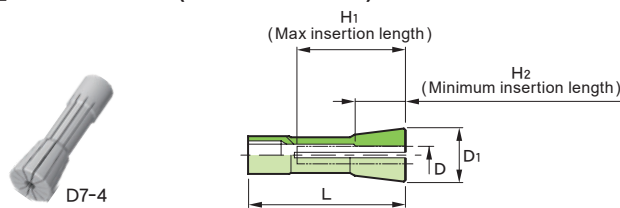

CODE	$\phi D$	L	$\phi C$	L1	kg	N	
<b>E25 -DTB 3- 58</b>	0.5 ~ 3.175	58	10	27	0.1	0.4	
<b>E32 -DTA 3- 75</b>	0.5 ~ 3.175	75	10	27	0.2	1.8	
<b>-DTB 3- 65</b>		65					0.6
<b>-DTB 7- 65K*</b>		1 ~ 7	21	30			0.9
<b>E40 -DTA 3- 75</b>	0.5 ~ 3.175	75	10	27	0.3	1.7	
<b>-DTB 3- 70</b>		70			0.3	0.9	
<b>-DTB 7- 95</b>	1 ~ 7	95	21	50	0.4	1.6	
<b>-DTB12-110</b>	2.5 ~ 13	110	30	90	0.5	2.8	
<b>E50 -DTA 3- 80</b>	0.5 ~ 3.175	80	10	27	0.5	2.1	
<b>-DTB 3- 75</b>		75				1.7	
<b>-DTB 7-100</b>	1 ~ 7	100	21	50	0.6	3.2	
<b>-DTB12-115</b>	2.5 ~ 13	115	30	89	0.8	4.2	
<b>F63 -DTA 3- 90</b>	0.5 ~ 3.175	90	10	27	0.8	2.3	
<b>-120</b>		120			0.9	2.7	
<b>-DTB 3- 75</b>		75			0.8	2.1	
<b>-105</b>		105			0.9	2.5	
<b>-105L</b>					57	0.8	2.1
<b>F63M-DTB 7-100</b>	1 ~ 7	100	21	50	0.9	3.3	
<b>-DTB12-120</b>	2.5 ~ 13	120	30	70	1.1	4.8	

CODE	$\phi D$	Collapsibility	$\phi D1$	L	H1	H2	Holder type
<b>D 3-0.6 -P</b>	0.5 ~ 0.6	0.1	7	40	36	6.9	DTA 3 DTB 3
<b>-0.8 -P</b>	0.6 ~ 0.8	0.2					
<b>-1 -P</b>	0.8 ~ 1	0.5					
<b>-1.5 -P</b>	1 ~ 1.5						
<b>-2 -P</b>	1.5 ~ 2						
<b>-2.5 -P</b>	2 ~ 2.5						
<b>-3 -P</b>	2.5 ~ 3						
<b>-3.175-P</b>	2.7 ~ 3.175						
<b>D 7- 1.5-P</b>	1 ~ 1.5						
<b>- 2 -P</b>	1.5 ~ 2						
<b>- 2.5-P</b>	2 ~ 2.5	1					
<b>- 3 -P</b>	2.5 ~ 3						
<b>- 4 -P</b>	3 ~ 4						
<b>- 5 -P</b>	4 ~ 5						
<b>- 6 -P</b>	5 ~ 6						
<b>- 7 -P</b>	6 ~ 7	1.5	26	70	50	16 20 22	DTB12
<b>D12- 4 -P</b>	2.5 ~ 4						
<b>- 6 -P</b>	4 ~ 6	2					
<b>- 8 -P</b>	6 ~ 8						
<b>-10 -P</b>	8 ~ 10						
<b>-12 -P</b>	10 ~ 12						
<b>-13 -P</b>	11 ~ 13						

- Option:
  - DETa-1 Collet
  - Wrench
- Std. Access.:
  - Rod(DTA3)
- Caution:
  - \*It cannot use collapsibility of a collet. The holding diameter applies only to the reference diameter of collet.
  - HSK-E and F shank don't come with a coolant duct and cannot be attached. Consult us if you need it.

### Accuracy

Runout accuracy	D3	D7-D12
<b>Precision Collet</b>	<b>3 (6)<math>\mu</math>m</b>	<b>5 (10)<math>\mu</math>m</b>

\*Accuracy of collet alone, ( ) means collapsibility usable.

D	L
~10	4 x D
10 ~ 13	40

## Spanner / Wrench

CODE	Shank type	Fig.	L	B	Tightening torque (N·m)
<b>F -22</b>	DTA 3	1	110	-	2~3
<b>DW-2.5-110</b>	DTB 3	2	103		
<b>TW-4</b>	E32 - DTB 7	3	77	4	14
	E40 - DTB 7	4	153	5	14
<b>-5</b>	E50 - DTB 7				
	F63M - DTB 7	5	110	5	14
	E40 - DTB12				18
	E50 - DTB12				
<b>W -135DR</b>	F63M - DTB12				

## Cleaning Tool felt type (DTA3 / DTB3)

Please use to clean the inside of the holder.

CODE	Q'ty
<b>PCT01-10</b>	10
<b>-25</b>	25

## Rod (DTA3 type)

The attaching to the DTA3 type holder.

CODE	Holder type	Q'ty
<b>PR-DTA3</b>	DTA3	2 pcs.

## COLLET HOLDER (CTH/CTS)



E32-CTH10-55



E32-CTS10-50

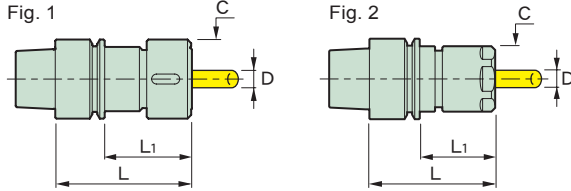

CODE	Fig.	$\phi D$	L	$\phi C$	L <sub>1</sub>	Kg
<b>E32-CTH10-55</b>	1	2.4 ~ 10	55	32	35	0.2
-CTS10-50 ※	2		50	26	30	
<b>E40-CTH10-55</b>	1	2.4 ~ 10	55	32	34	0.4
<b>E50-CTH10-60</b>	1	2.4 ~ 10	60	36	34	0.7
-90			90		64	0.9
-CTH20-75		5.8 ~ 20	75	50	49	
<b>F63-CTH10-60</b>	1	2.4 ~ 10	60	36	34	0.9
-90			90		64	1.1
-CTH20-75		5.8 ~ 20	75	50	49	

- Option** • Spring collet • Spanner  
**Caution** • ※=It cannot use collapsibility of a collet. The holding diameter applies only to the reference diameter of collet.

## Spring collet (Precision collet)

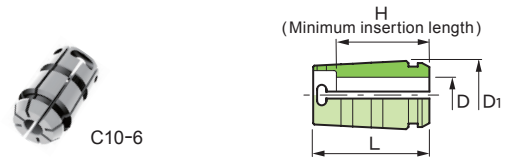

CODE	$\phi D$	L	$\phi D_1$	H	Holder type
<b>C10-D-P</b>	2.6 ~ 5.8 (0.2mm steps)	26	17.2	18	CTH10
	6 ~ 10 (0.2mm steps)			20	
<b>C20-D-P</b>	6 ~ 9.8 (0.2mm steps)	50	29.5	29	CTH20
	10 ~ 15.8 (0.2mm steps)			33	
	16 ~ 20 (0.2mm steps)			40	

ex.  $\phi D$   
C20-10-P

## Spanner / Wrench

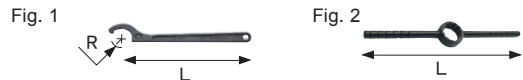

CODE	Fig.	Holder type	R	L
<b>FC-32</b>	1	E32 - CTH10	16	120
-36		F63 - CTH10	18	208
-50		- CTH20	25	281
<b>RC-26</b>	2	E32 - CTS10	—	240



## Accuracy

Runout accuracy	Nominal shank size
Precision Collet	5 $\mu m$

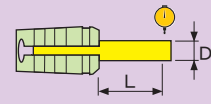

※Accuracy of collet alone

D	L
~ 10	4 × D
10.2 ~ 20	40

## Face Mill Arbor (FMC)



E50-FMC22-45

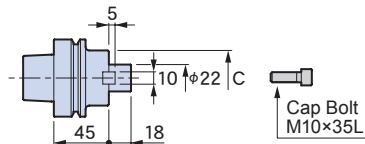

CODE	Cutter dia	$\phi C$	Kg
<b>E50-FMC22-45</b>	50, 63	42	0.7
<b>F63-FMC22-45</b>	50, 63	45	1

- Std. Access.** • Cap Bolt • Stopper Key  
**Note** • The cap bolt may differ depending upon the shape of the cutter

Feature

Shrink-fit Heater

MONO 3°  
MONO CURVE

MONO Series

2PIECE type

UNO

HYPER  
version

STRAIGHT  
arbor

OTHERS

PERIPHERALS

Technical  
Information

# Retention knob



## Caution

- Retention knobs in this catalog are typical models for various machine tool companies. Confirm the correct retention knob design using the machine specifications sheet.
- We manufacture other kinds of retention knobs. Please consult us for the detail.
- When heating Mono Series shrink-fit holders, use a retention knob with a through-hole or remove the retention knob before heating. If you use a retention knob without a through-hole for the Mono Series shrink-fit holders, a cutter cannot be inserted into the holder because the air in the holder is not released. We can provide you with a retention knob with an air drain hole.

Compatible manufacturers	Standard type						For through spindle coolant type		
	BT30		BT40		BT50		BT30	BT40	BT50
	Standard type	Standard type with a through hole	Standard type	Standard type with a through hole	Standard type	Standard type with a through hole			
BROTHER	P30T-2	P-511	-		-		P-511	-	-
DMG MORI	P30T-1	P-445	P-141	-	P-143	-	-	P-435	P-513
FANUC	P30T-1	P-522	-		-		P-522	-	-
HOWA	P30T-1	P-445	P40T-1	P-297	P50T-1	P-299	-	-	-
JTEKT	-		P40T-1	P-297	P50T-1	P-299	-	P-297	P-299
KIRA	P30T-1	P-445	P40T-1	P-297	-		-	P-323-1	-
KITAMURA	P30T-1	P-445	P-348		P-323-1		-	P-323-1	P-400
KIWA	P30T-1	P-445	P-348	P-323-1	P-400		-	P-323-1	P-400
KOMATSU NTC	P30T-1	P-445	P40T-1	P-297	P50T-1	P-299	P-522	P-505	P-384
KURASHIKI	-		P40T-1	P-297	P50T-1	P-299	-	-	-
MAKINO	-		P40T-1	P-297	P50T-1	P-299	-	-	-
MATSUURA	P30T-2	P-511	P-348		P-323-1		-	P-323-1	-
MAZAK	P-399		P-227		P-400		-	P-227	P-514
MITSUI SEIKI	-		P-007	-	P-008	P-250	-	-	-
NIDEC	-		P40T-1	-	P50T-2	-	-	-	-
NIIGATA MACHINE TECHNO	-		-		P50T-2	P-419	-	-	-
OHTORI	-		P40T-1	P-297	P50T-1	P-299	-	-	-
OKK	-		P40T-1	-	P-143		-	-	-
OKUMA	-		P40T-2	P-339	P50T-2	P-419	-	P-499	P-419
SHIBAURA MACHINE	-		(MB series)				-	-	-
SHIZUOKA	P30T-1	P-445	P-141	P-498	P-143	P-402	-	-	-
SNK	-		P40T-2	P-339	P50T-2	P-419	-	-	-
SUGINO	P30T-2	P-497	-		-		-	-	-
YAMAZAKI GIKEN	-		P40T-1	P-297	P50T-2	P-419	-	-	-
YASDA	-		P-348	P-438	P50T-1	P-299	-	P-509	P-585
					P-400 (YBM1218V)				

## BT30

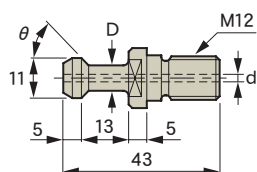

CODE	φD	φd	θ	NOTE
P30T-1	7	-	45	MAS-1
P-445		3		P30T-1 through hole
P30T-2		-	60	MAS-2
P-497		2		P30T-2 through hole
-522	8	4	45	FANUC center-through
-511	7.5	2.5	60	BROTHER center-through

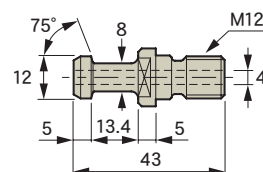

CODE	NOTE
P-399	JIS30P

## BT40

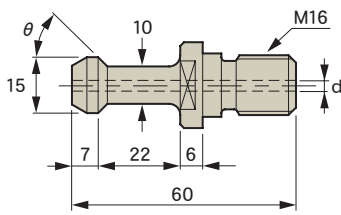

CODE	$\phi d$	$\theta$	NOTE
P40T-1	—	45	MAS-1
P-297	4		P40T-1 through hole
P40T-2	—	60	MAS-2
P-339	4		P40T-2 through hole
P-141	—	90	—
-498	4		P-141 through hole
P-505	3	45	KOMATSU NTC center-through

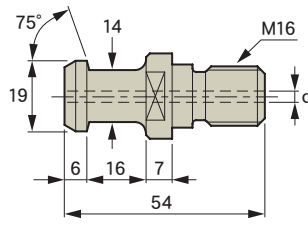

CODE	$\phi d$	NOTE
P-348	—	JIS40P
-323-1	7	P-348 through hole
-499	4	OKUMA center-through
-438	7	YASDA through hole
-509		YASDA center-through

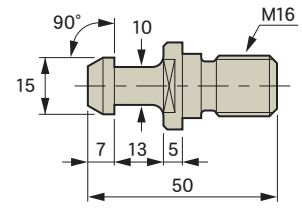

CODE	NOTE
P-007	MITSUI SEIKI

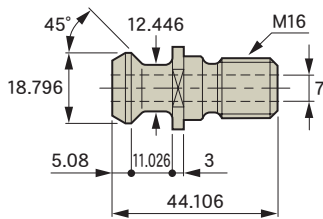

CODE	NOTE
P-227	MAZAK

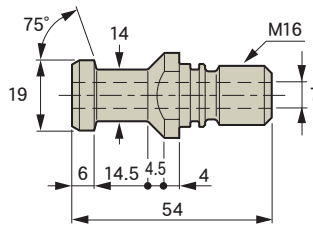

CODE	NOTE
P-435	DMG MORI center-through

## BT50

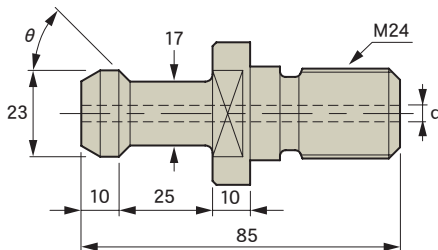

CODE	$\phi d$	$\theta$	NOTE
P50T-1	—	45	MAS-1
P-299	6		P50T-1 through hole
P50T-2	—	60	MAS-2
P-419	6		P50T-2 through hole
P-143	—	90	—
-402	7		P-143 through hole
-513	8	90	DMG MORI center-through
P-384	5.5	45	KOMATSU NTC center-through

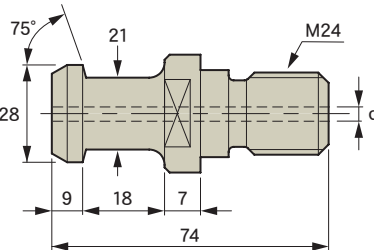

CODE	$\phi d$	NOTE
P-400	10	JIS50P
-288-1	6	P-400 through hole
-585	5.5	YASDA center-through

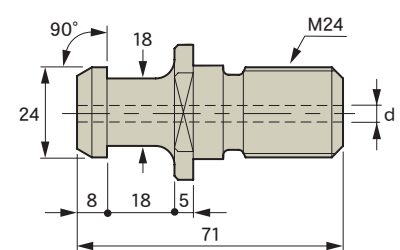

CODE	$\phi d$	NOTE
P-008	—	MITSUI SEIKI
-250	8	P-008 through hole

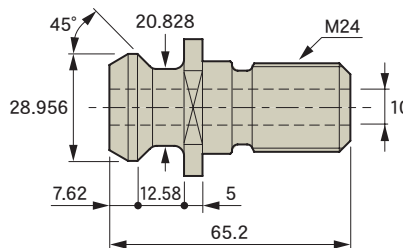

CODE	NOTE
P-514	MAZAK

### SLIMLINE collet installation

You can install a SLIMLINE collet without removing the retention knob if the center hole dia. is more than 6mm.



# Coolant duct (HSK-A)

## Coolant duct (Fixed type)

CODE	Fig.	$\phi C$	L	$\phi D$	W	G	Shank type
CD 40-01	1	8	29.5	4	4	M12×1	HSK-A40
-03	3		35.5				
-04			36.5				
CD 50-01	1	10	33	5	5	M16×1	HSK-A50
-03	3		39				
-04			59				
CD 63-01	1	12	36.5	6	6	M18×1	HSK-A63
-02	2						
-03	3				5		
-04			60.5				
CD100-01	1	16	44	8	8	M24×1.5	HSK-A100
-02	2			10.3			

### Note

- A coolant duct comes with below shank holders as a standard accessory. However, for the CD50-03 and the CD63-03, CD50-04 and CD63-04 come as options, respectively.

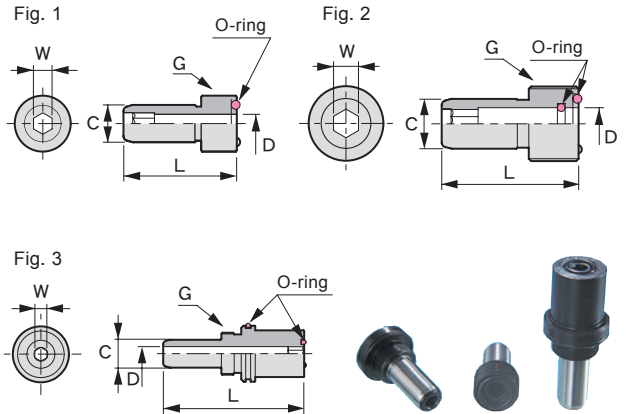

## Dummy duct

CODE	$\phi C$	L	W	G	Shank type
CD 40-A1	8	29.5	4	M12×1	HSK-A40
CD 50-A1	10	33	5	M16×1	HSK-A50
CD 63-A1	12	36.5	6	M18×1	HSK-A63
CD100-A1	16	44	8	M24×1.5	HSK-A100

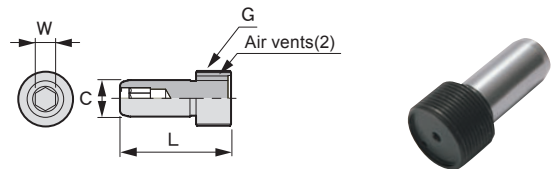

### ⚠ Cautions for shrinking operation.

Remove the coolant duct when using the hot air heater. If not, the O-ring will be damaged by the heat. (Removal is not necessary with the induction heater.) Use the dummy duct when the spindle coolant capability is not in use. The dummy duct does not need to be removed when heated.

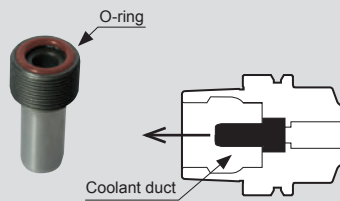

## Coolant duct (Swing type)

CODE	Fig.	$\phi C$	L	$\phi D$	G	Shank type
CD 63-01F	1	12	36.5	7	M18×1	HSK-A63
-03F	2		45.5	6.5		
CD100-01F	1	16	44	10	M24×1.5	HSK-A100

### Note

- Some machine tool companies recommend using a swing type coolant duct. We can exchange our standard fixed type coolant duct with a swing type at your request.
- If the replacement of the coolant duct is needed after the purchase, use the wrench CD63-01F-RNT.

