

Versatile Tool

- 157 <NT Shank> HARD CHUCK
- 157 <NT Shank> FACE MILL ARBOR (Type A)
- 158 <NT Shank> HARD CHUCK (A-set)
- 158 <NT Shank> HARD CHUCK (B-set)
- 159 <NT Shank> HARD CHUCK
- 160 <NT Shank> S-HOLDER (Q.C. Holder)
- 160 <S-HOLDER> SET
- 161 S-HOLDER BODY (Q.C. Holder)
- 161 <S-HOLDER> TAPER SLEEVE (S1 Collet)
- 162 <S-HOLDER> HARD CHUCK (S2 Collet)
- 162 <S-HOLDER> FACE MILL ARBOR (S3 Collet)
- 163 <S-HOLDER> SIDE CUTTER ARBOR (S4 Collet)
- 163 <S-HOLDER> DRILL CHUCK HOLDER (S6 Collet)

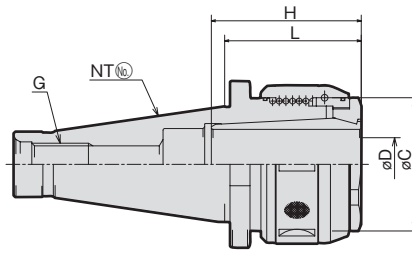



MODEL	CODE	øD	L	øC	H	G
NT30W -CTH20	33004	20	62	60	50	w ¹ / ₂ -12
NT40 ^U _(M) -CTH25	33006 (33026)	25	65	68	68	5/8-11UNC (M16×2)
-CTH32	33008 (33028)	32	82.6	80	70(Short)	
NT50 ^U _(M) -CTH32	33010 (33030)	32	76.2	80	80	1-8UNC (M24×3)
-CTH42	33012 (33032)	42	82	95	90	
-CTH50(50.8)	33014 (33034)	50(50.8)	120	105	95	

NOTE : 1. Chuck wrench is included.

ACCESSORIES
P.48 ADJUST SCREW

ACCESSORIES
P.47-49 SPRING COLLET, CHUCK WRENCH

ORDERING EXAMPLE			
①	NT30	②	W
	-	③	CTH
		④	20
①	Shank Size		
②	G type		
③	Name		
④	Cutter's Dia. øD		

<NT Shank> FACE MILL ARBOR (Type A) NT^(No) G₂-FMA^(D)-L

FIG. 1

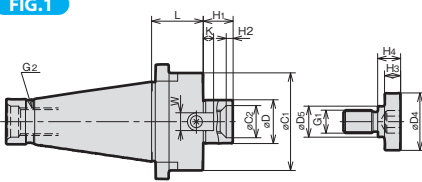

FIG. 2

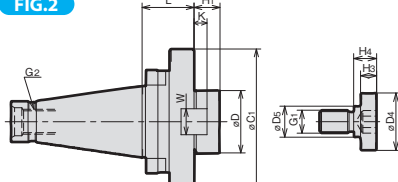
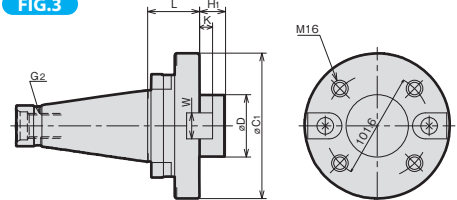

FIG. 3



MODEL	CODE	FIG.	øD(h6)	L	øC1	øC2	H1	H2	KEY		G1	CLAMP BOLT				G2	N/W (kg)	
									W	K		øC4	øC5	H3	H4			
NT40 ^U _(M)	-FMA25.4 -030	35702 (35704)	1	25.4	30	50	—	22	—	9.5	5	M12	33	23	10	12	5/8-11UNC (M16×2.0)	
	-FMA31.75 -030	35706 (35708)		31.75		60	24	30	6	12.7	7	M16	40	23		16		
	-FMA38.1 -030	35710 (35712)	2	38.1		80	28	34	—	15.9	9	M20	50	27	20			
	-FMA50.8 -030	35714 (35716)		50.8		98	38	36	10	19.05	10	M24	65	37	24			
NT50 ^U _(M)	-FMA25.4 -030	35720 (35722)	1	25.4	45	50	—	22	—	9.5	5	M12	33	23	10	12	1-8UNC (M24×3.0)	3.5
	-FMA31.75 -030	35724 (35726)		31.75		60	24	30	6	12.7	7	M16	40	23		16		
	-FMA38.1 -030	35728 (35730)		2		38.1	80	28	34	—	15.9	9	M20	50	27	20		
	-FMA50.8 -030	35732 (35734)				50.8	98	38	36	10	19.05	10	M24	65	37	24		
	-FMA47.625-045	35736 (35738)	3	47.625		45	128.57	—	38	—	25.4	12.5	—	—	—	—		

ORDERING EXAMPLE					
①	NT50	②	U _(M)	③	FMA
		④	31.75	⑤	030
①	Shank Size				
②	G2 type				
③	Name				
④	D				
⑤	L				

<NT Shank> HARD CHUCK (A-set)

NT (No) (G) - CTH (D) A



ORDERING EXAMPLE				
①	NT30	②	W	-
		③	CTH	④
				20
				⑤
				A

- ① Shank Size
- ② Thread type
- ③ Name
- ④ Cutter's Dia. øD
- ⑤ Set type

MODEL	CODE	HARD CHUCK	STRAIGHT COLLET	HOOK SPANNER
NT30W -CTH20 A	33302	NT30W -CTH20	SC20-06,08,10,12,16	FS58-62G
NT40U(M)-CTH25 A	33304 (33404)	NT40U(M)-CTH25	SC25-06,08,10,12,16,20	FS68-75G
NT40U(M)-CTH32 A	33306 (33406)	NT40U(M)-CTH32	SC32-06,08,10,12,16,20,25	FS80-90G
NT50U(M)-CTH32 A	33308 (33408)	NT50U(M)-CTH32	SC32-06,08,10,12,16,20,25	FS80-90G
NT50U(M)-CTH42 A	33310 (33410)	NT50U(M)-CTH42	SC42-06,08,10,12,16,20,25,32	FS92-100

NOTE : Please refer to P.139 for dimensions of HARD CHUCK.

BT series

HSK series

ST series

Versatile Tool

Cutting Tool

Accessories

<NT Shank> HARD CHUCK (B-set)

NT (No) (G) - CTH (D) B



ORDERING EXAMPLE				
①	NT30	②	W	-
		③	CTH	④
				20
				⑤
				B

- ① Shank Size
- ② Thread type
- ③ Name
- ④ Cutter's Dia. øD
- ⑤ Set type

MODEL	CODE	HARD CHUCK	STRAIGHT COLLET	TAPER COLLET	DRILL CHUCK ARBOR	HOOK SPANNER
NT30W -CTH20 B	33322	NT30W -CTH20	SC20-06,08,10,12,16	20-MT1,MT2	20-J6	FS58-62G
NT40U(M)-CTH25 B	33324 (33424)	NT40U(M) -CTH25	SC25-06,08,10,12,16,20	25-MT1,MT2	25-J6	FS68-75G
NT40U(M)-CTH32 B	33326 (33426)	NT40U(M) -CTH32	SC32-06,08,10,12,16,20,25	32-MT1,MT2,MT3	32-J6	FS80-90G
NT50U(M)-CTH32 B	33328 (33428)	NT50U(M) -CTH32	SC32-06,08,10,12,16,20,25	32-MT1,MT2,MT3	32-J6	FS80-90G
NT50U(M)-CTH42 B	33330 (33430)	NT50U(M) -CTH42	SC42-06,08,10,12,16,20,25,32	42-MT1,MT2,MT3,MT4	42-J6	FS92-100

NOTE : Please refer to P.139 for dimensions of HARD CHUCK.

FEATURES

- The ball screw structure provides high clamping power.
- Easy handling.
- High accuracy and rigidity are kept long.

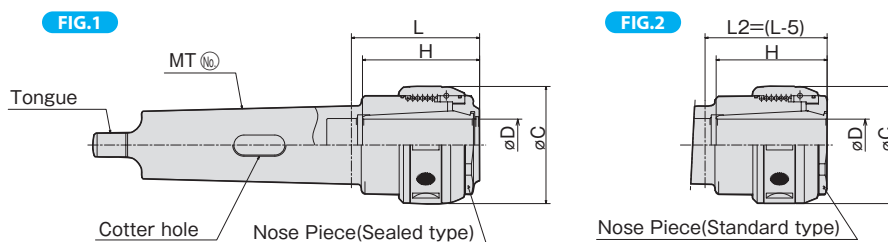

MODEL	FIG	øD	L	øC	H
MT4-CTH25	2	25	86.5	68	60
-CTH32		32	98.5	83	80
MT5-CTH32	1	32	103.5	83	85
-CTH42		42	117.5	95	95
MT6-CTH32	1	32	84	83	85
-CTH42		42	104	95	95
-CTH50(50.8)		50(50.8)	120	105	100
MT7-CTH42	1	42	80	95	95
-CTH50(50.8)		50(50.8)	115	105	100

NOTE: 1. Please inform machine maker and model, when ordering with cotter hold which differs depending on them.

ORDERING EXAMPLE			
①	②	③	④
MT5	-	CTH	25
① Shank Size		② Name	
③ Cutter's Dia. øD		④ Machine maker	

ACCESSORIES
 P.47 SPRING COLLET

ACCESSORIES
 P.48 STRAIGHT COLLETS, ADJUST SCREW

ACCESSORIES
 P.49 CHUCK WRENCH

<NT Shank> S-HOLDER (Q.C. Holder)

S-HOLDER

An ace of quick change holders



Tool change can be done in **3 seconds.**

High rigidity makes the holder possible to use a 200mm(8") face mill.

FEATURES

SHOWA s-Holder is the most safe, strong and speedy (3S) quick change holder, with variety of sub-holders.

Safe

The outstanding chucking ability of S-Holder assures safety operations.

Strong

Up to a 200mm(8") face mill can be used due to the highest rigidity of the holder.

Speedy

Sub-holders can be changed quick by the forced load and unload mechanism (PAT.831025) eliminating the use of a hammer.

<S-HOLDER> SET

S NT No. - HARD CHUCK SIZE

ORDERING EXAMPLE

① S ② 40U - ③ 25

- ① Name
- ② Spindle NT No.
- ③ HARD CHUCK Size

SET CODE	S40U-25	S40U-32	S50U-32	S50M-32	S50U-42	S50M-42
	36002	36004	36006	36007	36008	36009
SPINDLE NT No.	NT40-U	NT40-U	NT50-U	NT50-M	NT50-U	NT50-M
S-Holder Body	S40U	S40U	S50U	S50M	S50U	S50M
TAPER SLEEVE	40S1-MT3		50S1-MT4			
HARD CHUCK	40S2-25	40S2-32	50S2-32		50S2-42	
FACE MILL ARBOR	40S3-F4		50S3-F6			
STRAIGHT COLLET	SC25-06,08 10,12,16,20	SC32-06,08,10 12,16,20,25	SC32-06,08,10 12,16,20,25		SC42-06,08,10 12,16,20,25,32	
TAPER COLLET	25-MT1,MT2	32-MT2,MT3	32-MT2,MT3		42-MT2,MT3	
DRILL CHUCK ARBOR	25-J6	32-J6	32-J6		42-J6	
HOOK SPANNER	FS68-75 FS80-90	FS80-90	FS80-90 FS110-115		FS92-100 FS110-115	
HEXAGON WRENCH	B14		B17			

S-HOLDER BODY (Q.C. Holder)

S **NT No.** **G**-HOLDER

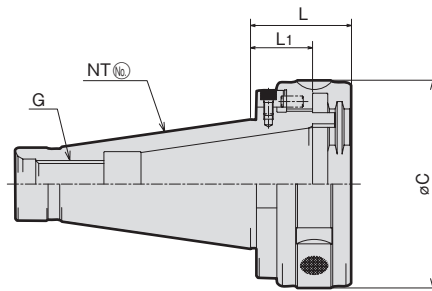

MODEL	CODE	NT No.	L ₁	L	øC	G
S40U-HOLDER	36012	NT40	30.85	44.85	87	5/8-11UNC
S50U-HOLDER	36102	NT50	33.45	54.45	112	1-8UNC
S50M-HOLDER	36103	NT50	33.45	54.45	112	M24×3

ORDERING EXAMPLE

① S ② 40 ③ U - ④ HOLDER

① Name

② NT No.

③ G type

<S-HOLDER> TAPER SLEEVE (S₁ Collet)

NT No. S₁-MT No.

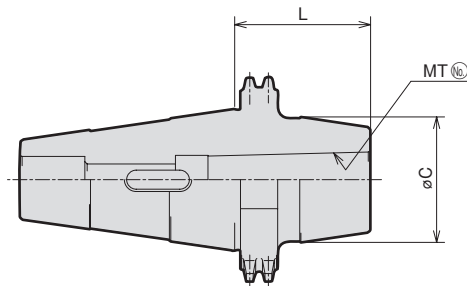

MODEL	CODE	MT No.	L	øC
40S ₁ -MT1	36014	MT1	52	40
-MT2	36016	MT2	52	40
-MT3	36018	MT3	62	41
-MT4	36020	MT4	100	41
50S ₁ -MT1	36104	MT1	93.5	44
-MT2	36106	MT2	58.5	54
-MT3	36108	MT3	58.5	54
-MT4	36110	MT4	58.5	54
-MT5	36112	MT5	110	61

ORDERING EXAMPLE

① 40 ② S₁ - ③ MT1

① NT No.

② Name

③ MT No.

<S-HOLDER> **HARD CHUCK** (S₂ Collet)

FEATURES p.7-8

NT No. **S₂-D**

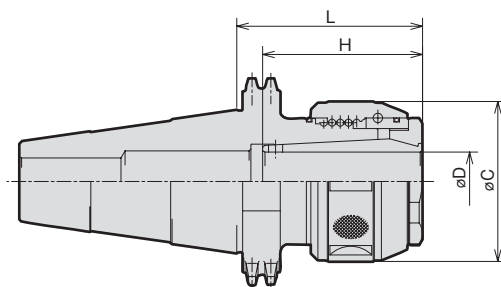

MODEL	CODE	øD	L	øC	H
40S ₂ -25	36022	25	70	68	68
-32	36024	32	95	83	70
50S ₂ -32	36122	32	80	83	80
-42	36124	42	99	95	90

NOTE : 1. Please refer to P.41 for chuck wrench.
2. Please refer to P.40 for spring collet and P.40 for straight collet.

ORDERING EXAMPLE

① ② ③
40 S₂ - 25

① NT No.
 ② Name
 ③ Cutter's Dia. øD

- ACCESSORIES
P.47 **SPLING COLLET**
- ACCESSORIES
P.48 **STRAIGHT COLLETS**
- ACCESSORIES
P.49 **CHUCK WRENCH**

<S-HOLDER> **FACE MILL ARBOR** (S₃ Collet)

NT No. **S₃-F** Dia.(in)

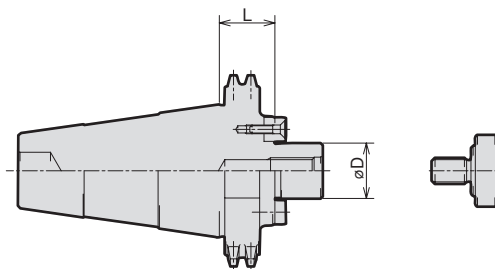

MODEL	CODE	øD	L	Face Mill Dia.
40S ₃ -F3	36032	25.4	19	80 (3")
-F4	36034	31.75	19.5	105 (4")
-F5	36036	38.1	28	125 (5")
-F6	36038	50.8	31	160 (6")
50S ₃ -F3	36132	25.4	25.5	80 (3")
-F4	36134	31.75	26	105 (4")
-F5	36136	38.1	27.5	125 (5")
-F6	36138	50.8	37.5	160 (6")
-F8	36140	47.625	47.5	200 (8")

ORDERING EXAMPLE

① ② ③ ④
40 S₃ - F 3

① NT No.
 ② Name
 ③ Name
 ④ Cutter's Dia.

BT series
HSK series
ST series
Versatile Tool
Cutting Tool
Accessories

<S-HOLDER> **SIDE CUTTER ARBOR** (S₄ Collet)

NT No. **S₄-D-L₂**

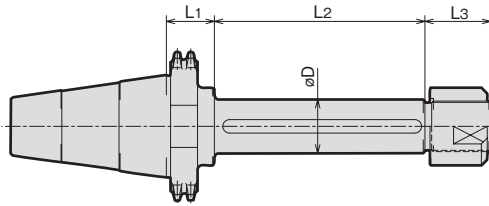

MODEL	CODE	ϕD	L1	L2	L3
40S4-25.4 -075	36042	25.4	22	75	33
50S4-25.4 -100	36152	25.4	28.5	100	33
50S4-31.75-125	36154	31.75	28.5	125	39

ORDERING EXAMPLE

① **40** ② **S₄** - ③ **25.4** ④ **075**

- ① NT No.
- ② Name
- ③ ϕD
- ④ L2

<S-HOLDER> **DRILL CHUCK HOLDER** (S₆ Collet)

NT No. **S₆-J^(No)**

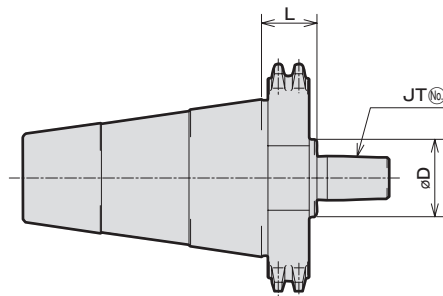

MODEL	CODE	JT No.	L	ϕC
40S ₆ -J6	36044	6	17	30
50S ₆ -J6	36162	6	21.5	30

ORDERING EXAMPLE

① **40** ② **S₆** - ③ **J6**

- ① NT No.
- ② Name
- ③ JT No.